



The Looselay Story

we **care** / we **act**

Gerflor[®]



Contents

- 05. **Looselay**
- 06. **Our commitments for a sustainable future**
- 08. **Beginning with resources**
- 10. **The looselay story: saving time and costs**
- 12. **The looselay story: ending with circularity**
- 14. **The looselay offer**
- 16. Luxury Vinyl Tile
- 17. Fast Track Tiles
- 18. Safety Flooring
- 19. Multi-layered Vinyl
- 20. Textile Backed Vinyl
- 21. Sports Flooring
- 22. Carpets
- 23. Matting
- 24. **Olympics Case Study**
- 25. **Success Stories**

gerflor.co.uk / follow us:





Looselay

What is looselay flooring?

Looselay flooring refers to a **type of flooring that is not permanently adhered to the substrate**. Despite the absence of traditional adhesives, looselay floorcoverings maintain stability and durability compared to fully bonded floorcoverings, thanks to their innovative design.

This brochure aims to provide a comprehensive overview of the benefits of the different types of looselay flooring throughout its life-cycle, catering to end-users, specifiers, and installers alike.

Why choose looselay flooring?

Looselay flooring is engineered for **quick and easy installation** without the need for permanent adhesives. Gerflor design their looselay flooring with environmental considerations in mind, incorporating recycled and recyclable materials into most products.

The absence of permanent adhesives also **reduces VOC emissions**, enhancing indoor air quality for healthier environments. During installation, looselay flooring **requires reduced sub-floor preparation** and selected ranges are suitable for damp subfloors, resulting in significant **time and cost savings**.

The rapid installation process **minimises downtime and disruption**, allowing premises to remain operational. Looselay products are durable and many feature surface treatments that reduce the amount of water and detergent used during cleaning processes, reducing the operational carbon impact of products in use.

When no longer needed, looselay flooring can be **easily uplifted** without damage, facilitating **reuse in future** projects or **recycling**, thereby contributing to sustainability.



Time Saving



Easy Installation



No Permanent Bond



Reuse or Recycle

Our commitments for a sustainable future

Our customers are our priority

The most popular Gerflor designs are now available in a looselay format. Eco-design is implemented at each stage of the product life cycle. Ideal for new build and renovations, when time is critical.

The 4 stages of a products life cycle



Manufacturing

- Gerflor looselay products contain on average between 19% and 80% recycled content
- Selected ranges stocked in the UK for quick turnaround projects
- European manufacturing reduces the distance from factory gate to site

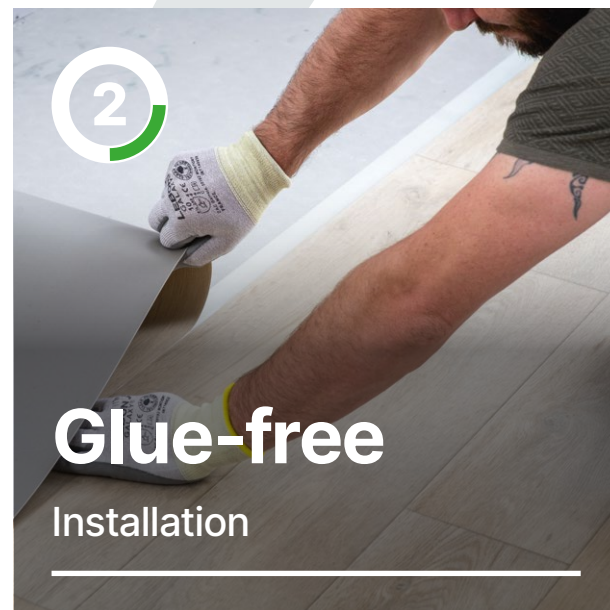

Installation

- Faster and easier to install than permanently bonded floorcoverings
- Can be installed over most existing hard floors
- Selected looselay flooring can be installed over damp subfloors
- Can be walked on immediately after installation

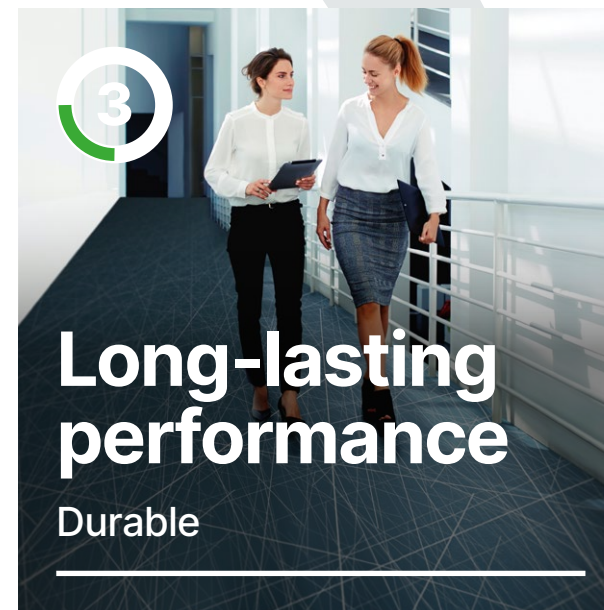

In Use

- Surface treatments on resilient flooring makes cleaning easier and reduces water and detergent use
- Our durable looselay products have an average service life of 25 years
- Repairing looselay flooring is easier compared to permanently bonded floorcoverings

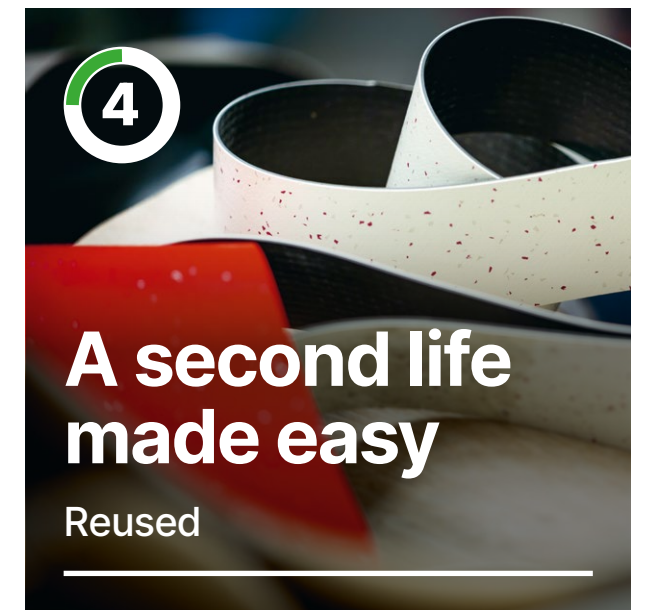

End-of-Life

- Less energy, time and resources to remove
- Easier to recycle and re-manufacture into new products
- Can be reused and re-purposed on new projects
- Reduces the impact on new raw material extraction

Looselay

Means more projects finished faster even in busy environments, with less disruption by dust, smell and noise

Beginning with resources

“Drives down the carbon impact for new build & refurbishment projects”

Gerflor looselay products contain on average between 19% and 80% recycled content. This use of sustainable materials helps to reduce our impact on the earth's finite resources.

A selection of our looselay floorcoverings have been specifically designed for installation on damp subfloors. This capability eliminates the need for sub-floor preparation materials, such as surface damp-proof membranes, thereby reducing the consumption of additional resources.

Our looselay flooring is engineered to provide outstanding stability, even during temperature fluctuations. This resilience ensures the flooring maintains its integrity and performance, regardless of environmental changes.



Did you know?

Bio-based materials tend to have a low carbon impact

We confidently provide a 10-15 year warranty for most of our products which provides you with long-term reliability and durability. This extended lifespan significantly reduces the need for frequent replacements which minimises waste and helps reduce the impact on resources. By choosing our products, you can ensure that your flooring retains its function and appearance for many years.

We offer Environmental Product Declaration's (EPD's) for our floorcoverings, and they offer transparent and standardised information about the carbon impact of our products. EPD's provide detailed insights into how our products contribute to the overall carbon footprint of an installation, enabling informed decision-making for environmentally conscious projects.

Our looselay products are fully compliant with REACH (Registration, Evaluation, Authorisation and Restriction of Chemicals) legislation. This compliance ensures that our products do not contain any toxic or harmful materials or chemicals, safeguarding both human health and the environment.



The looselay story: saving time and costs

“On average, looselay vinyl sheet saves approximately 50% installation time*”

Looselay products provide a faster and easier installation process compared to fully-adhered flooring.

This efficiency is particularly beneficial in time-critical environments such as healthcare and retail, where minimising disruption is crucial. The quick installation process ensures that these spaces can remain operational with reduced downtime.

One of the standout features of looselay flooring is its ability to be installed over most existing hard floors. **This makes it an excellent choice for refurbishment projects, as it simplifies the installation process and reduces the need for removing existing hard floors.**

Looselay flooring requires minimal sub-floor preparation, with some providing the ability to be installed over newly laid damp-subfloors **which makes it an ideal solution for new build projects.** This not only speeds up the installation process, but it also translates to lower material and labour costs.

Once installed, looselay flooring **can be walked on immediately. This means downtime is reduced and there is less impact on operations.** This is especially important in busy environments where prolonged closures are not feasible.

The absence of permanent adhesives in looselay flooring tiles simplifies the repair process. **When damage occurs, individual sections of the flooring can be easily lifted and replaced** without disturbing the sub-floor and surrounding area.

Some of our floorcoverings have an innovative surface treatment as standard, offering outstanding stain resistance. Our surface treatments make cleaning quicker and optimise operational efficiency by reducing water consumption and detergent use.

*Compared to fully-adhered vinyl sheet flooring.



Did you know?

Cleaning and maintenance represent on average, 18-38% of the floorcoverings overall carbon footprint



The looselay story: ending with circularity

“Looselay flooring can be easily removed, reused and recycled to give it a second life”

At the end of the products life, **looselay flooring can be swiftly removed with minimal effort**, ideal for quick turnaround projects or busy spaces. The removal of looselay flooring **doesn't cause any damage to the underlying sub-floor**, with no residues left and no aggressive methods required to remove.

The adhesive-free nature of looselay flooring offers significant advantages at the end of its initial life-cycle. Without the constraints of permanent adhesives, these products can be **easily uplifted and potentially reused on new projects**.

This capability **to re-purpose the flooring provides it with a second life**, extending its usability and helping the conservation of the Earth's resources.

Looselay flooring is designed to be 100% recyclable, offering a significant environmental advantage over single-use products. At the end of its life, **looselay flooring can be fully processed and re-purposed into new materials**, diverting waste from landfill and reducing the demand for virgin resources.

This recyclability ensures the materials used in the flooring can be cycled through the production process to **support a circular economy**.



Did you know?

Adhesive-free flooring can be more easily recycled and reused than fully adhered flooring



The looselay offer:

“Over 27 ranges, driving our commitment to reducing our impact on the planet.”



Range	Application	Format	Installation	Subfloor****
LVT				
Creation 70 Clic	General	Tile / Plank	Clic	New and Existing Substrates, Ceramics (5mm (w) x 2mm (d)) ≤92% RH*
Creation 70 Looselay	General	Tile / Plank	Tackifier	New and Existing Substrates, ≤75% RH
Creation 55 Solid Clic	General	Tile / Plank	Clic	New and Existing Substrates, ≤92% RH*
Creation 55 Rigid Acoustic	General / Acoustic	Tile / Plank	Clic	New and Existing Substrates, Ceramics (8mm (w) x 3mm (d)) ≤75% RH
Creation 55 Looselay	General	Tile / Plank	Looselay or Tackifier**	New and Existing Substrates, ≤75% RH
Creation 40 Solid Clic	General	Tile / Plank	Clic	New and Existing Substrates, ≤92% RH*
Creation 40 Rigid Acoustic	General / Acoustic	Tile / Plank	Clic	New and Existing Substrates, Ceramics (8mm (w) x 3mm (d)) ≤75% RH
Creation 30 Solid Clic	General	Tile / Plank	Clic	New and Existing Substrates, ≤92% RH*
Creation Zen	General / Acoustic	Tile / Plank	Takifier	New and Existing Substrates, ≤75% RH
Creation 70 Connect	General	Tile	Dove Tail	New and Existing Substrates (including mild damaged***), ≤92% RH
Saga ²	General / Acoustic	Tile	Tackifier	New and Existing Substrates, Raised Access Flooring, ≤75% RH
Fast Track Tiles				
GTI Max	Heavy Duty	Tile	Dove Tail	
Design Tile	Heavy Duty	Tile	Dove Tail	New and Existing Substrates (including mild damaged***), ≤92% RH
Industrial Tile	Heavy Duty	Tile	Dove Tail	
Attraction	Heavy Duty	Tile	Dove Tail	
Multi-layered Vinyl				
Tarasafe Impression HOP	Safety	Sheet	Looselay	New and Existing Substrates, ≤97% RH
Taralay Impression HOP	Safety	Sheet	Looselay	New and Existing Substrates, ≤75% RH
Taralay Libertex	General	Sheet	Looselay	
Residential Textile Backed				
Griptex	General	Sheet	Looselay	New and Existing Substrates, ≤75% RH
Texline	General	Sheet	Looselay	
Sports Floors				
Taraflex Evolution SL	Sports	Sheet	Looselay	New and Existing Substrates (Clean and Smooth), ≤92%RH
Taraflex Performance SL	Sports	Sheet	Looselay	
Carpets				
Premium Collection	General	Tile	Tackifier	Clean, Smooth, Dry Substrate, Raised Access Floors
Contractor Collection	General	Tile	Tackifier	
Matting				
Esplanade	Entrance	Strip	Looselay	
Mat-in-a-Box	Entrance	Strip	Clic	Clean, Smooth, Dry Substrate
Access	Entrance	Strip	Looselay	

* Refers to products installed without an acoustic underlay

** Over 30m² tackifier required

*** Surface unevenness and % damage varies per product, please refer to the installation guidelines

**** Subfloor - refer to the full installation guide for details

Luxury Vinyl Tile

The Creation LVT Collection is a tried and tested looselay tile and plank solution with formats suitable for heavy, medium and low traffic applications. Providing endless design possibilities and easy to install Zen, Solid Clic, Rigid Acoustic, Looselay and Looselay Acoustic formats.

The looselay offer:
Creation 70, 55, 40, 30
Creation Zen
Creation 70 Connect
Saga²
[Visit our website](#)



Fast Track Tiles

The Technical Tiles collection is made up of hardwearing tiles that feature dovetailed interlocking edges to allow for rapid looselay installation and replacement. Highly durable and suitable for medium to heavy pedestrian and wheeled traffic applications such as retail and industry.

The looselay offer:
Attraction
GTI Max
Design Tile
Industrial Tile
[Visit our website](#)

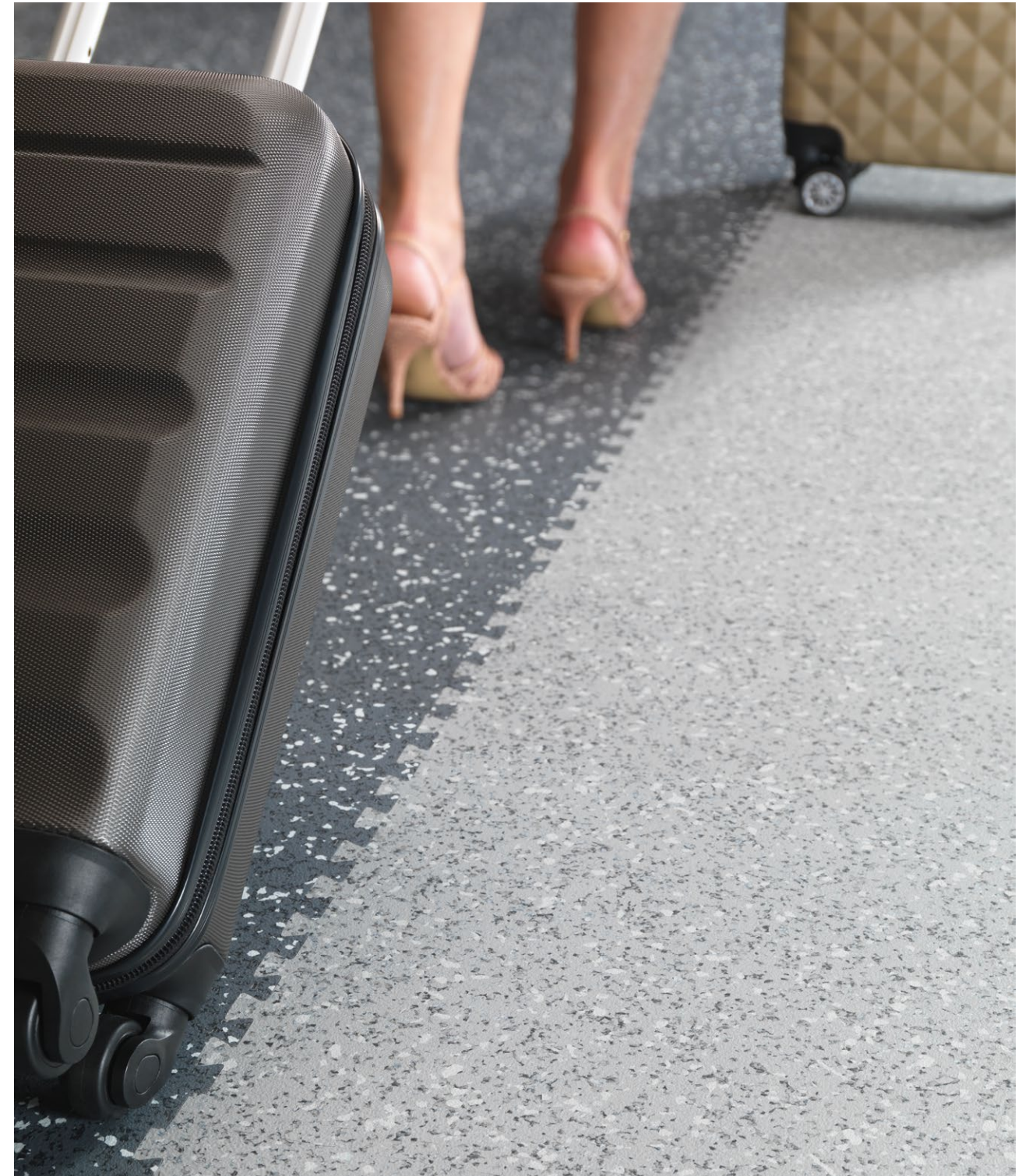

Safety Flooring

Tarasafe Impression Hop is a looselay vinyl safety flooring range that offers 36+ HSE compliant slip resistance, durability and outstanding performance. It is suitable for heavy traffic areas, and is an eco-friendly, fast track product that can be laid over most existing floorcoverings.

The looselay offer:
Tarasafe Impression HOP
[Visit our website](#)



Multi-layered Vinyl

The Taralay multi-layered vinyl collection contains a choice of Taralay Libertex and Taralay Impression Hop Compact & Acoustic in a looselay format. Suitable for commercial environments and available in a wide choice of wood, mineral, plain, graphic and textile designs.

The looselay offer:
Taralay Impression HOP
Taralay Libertex
[Visit our website](#)

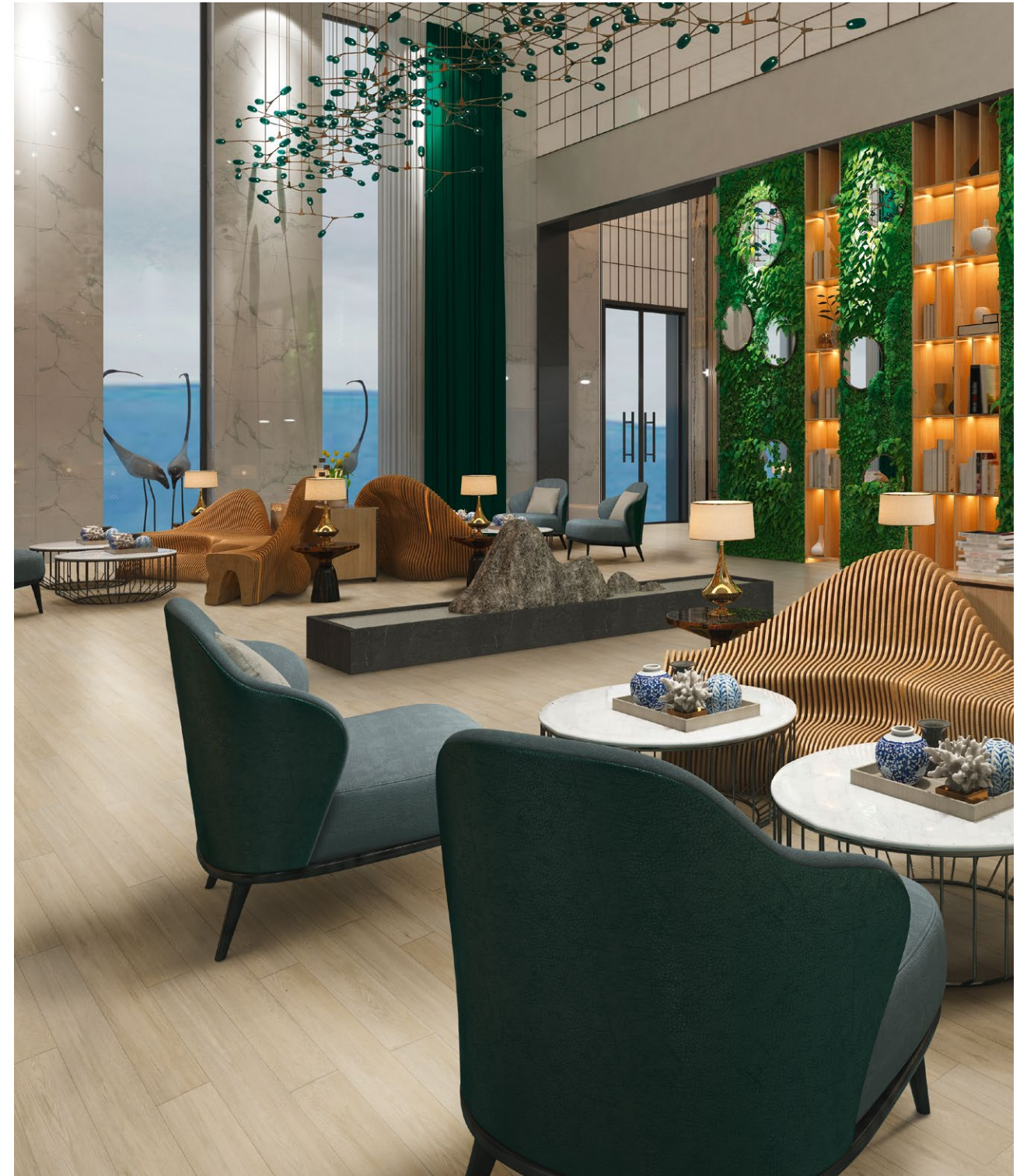

Textile Backed Vinyl

Griptex and Texline are warm, comfortable and slip-resistant vinyl floor coverings that are ideal for housing applications. Water resistant from above and below, with a hygienic and easy to clean Pureclean surface treatment.

The looselay offer:

Griptex
Texline

[Visit our website](#)



Sports Flooring

The Taraflex Sustainable Looselay collection contains a choice of Taraflex Evolution SL P1 or Taraflex Performance SL P2 sports flooring in a revolutionary easy, fast and looselay installation. Containing up to 81% natural or recycled materials combining sustainability and great sports performance and durability.

The looselay offer:

Taraflex Evolution SL
Taraflex Performance SL

[Visit our website](#)



Carpets

The Gradus Carpet collection is a wide range of high-performance carpet tiles and planks for heavy commercial applications. Featuring in a wide choice of designs and colours to balance aesthetics with durability.

The looselay offer:
Premium Collection
Contractor Collection
[Visit our website](#)



Matting

The Gradus Barrier Matting collection is a range of primary and hybrid solutions that provide optimal levels of dirt and moisture removal to help reduce slips and extend the lifespan of surrounding floorcoverings.

The looselay offer:
Esplanade
Mat-in-a-Box
Access
[Visit our website](#)

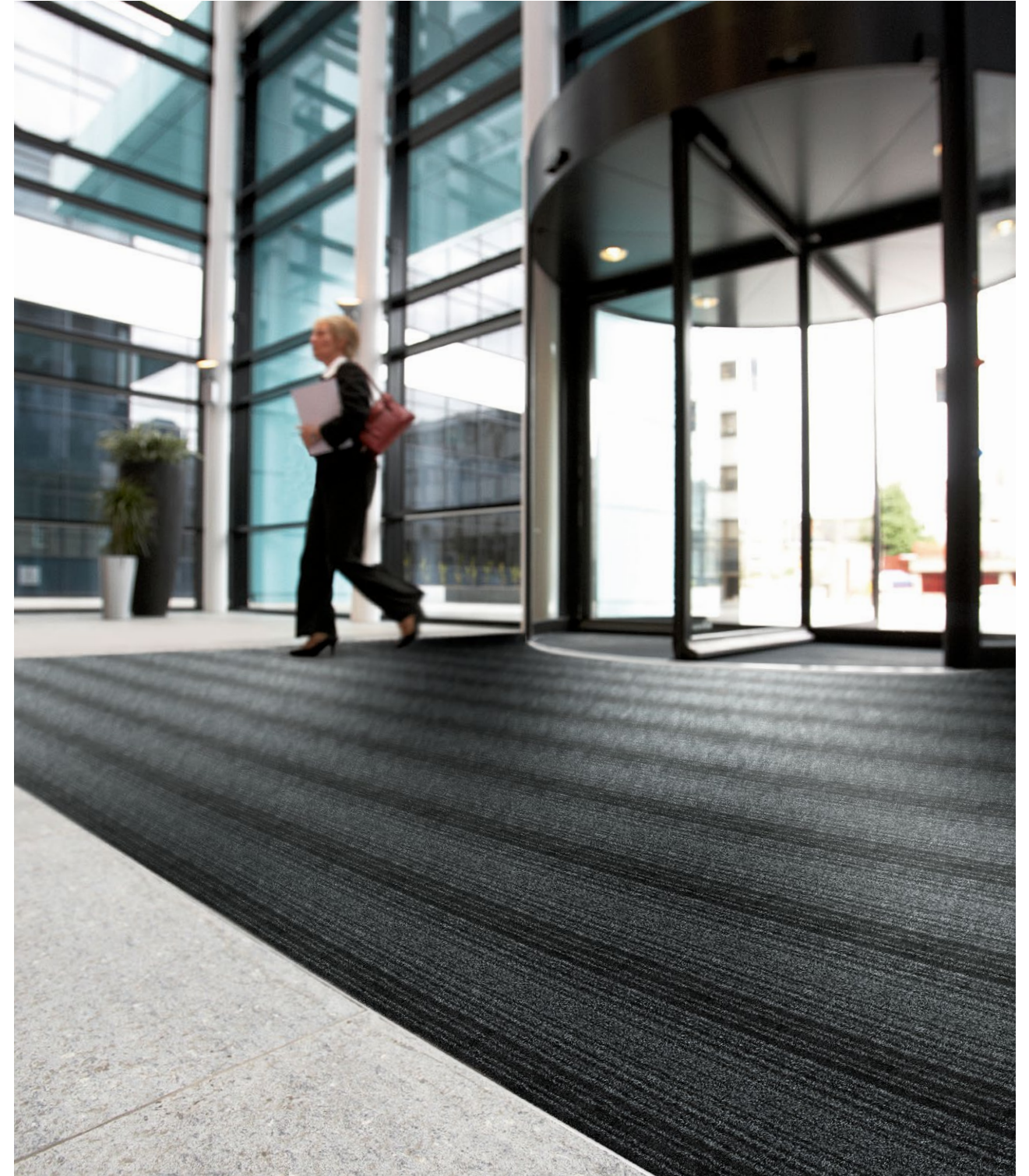

Olympics Case Study

100% of the Taraflex Sustainable Looselay flooring installed and used during the Paris 2024 Olympics is currently being re-purposed in various sports halls and gymnasiums across France. This initiative involves 40 sports surfaces, covering a total area of 33,000 square meters.

The innovative looselay installation method has facilitated the reuse of these sports floors, providing many amateur athletes and schoolchildren the unique opportunity to play on Olympic-standard flooring.

Among the facilities benefiting from this initiative is the CREPS in Strasbourg, which now features the same flooring used for the Paris 2024 Handball games. Additionally, a commune in Carpiquet has re-purposed the flooring from the Volleyball finals.

This remarkable effort not only promotes sustainability but also inspires future generations of athletes by connecting them to the legacy of the Paris 2024 Olympics. It stands as a testament to the enduring impact of innovative and environmentally conscious practices in sports infrastructure.



Success Stories

Sealife Centre Brighton
GTI Max Technical Tile

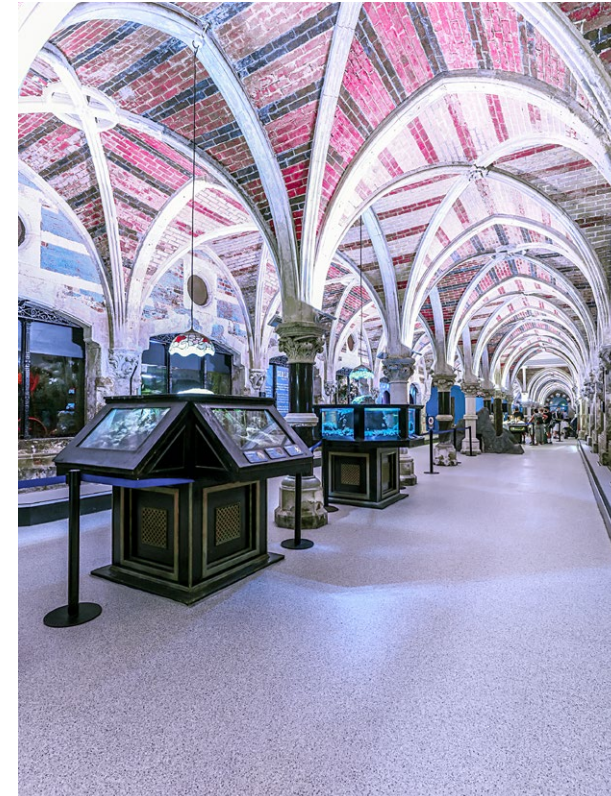

Monmouthshire Building Society Cardiff
Creation 70 Looselay LVT



Langford Budville Hall Somerset
Taralay Libertex Multi-layered Looselay Vinyl



Mahindra Advanced Design Europe Offices Banbury
Lunar Carpet Tiles

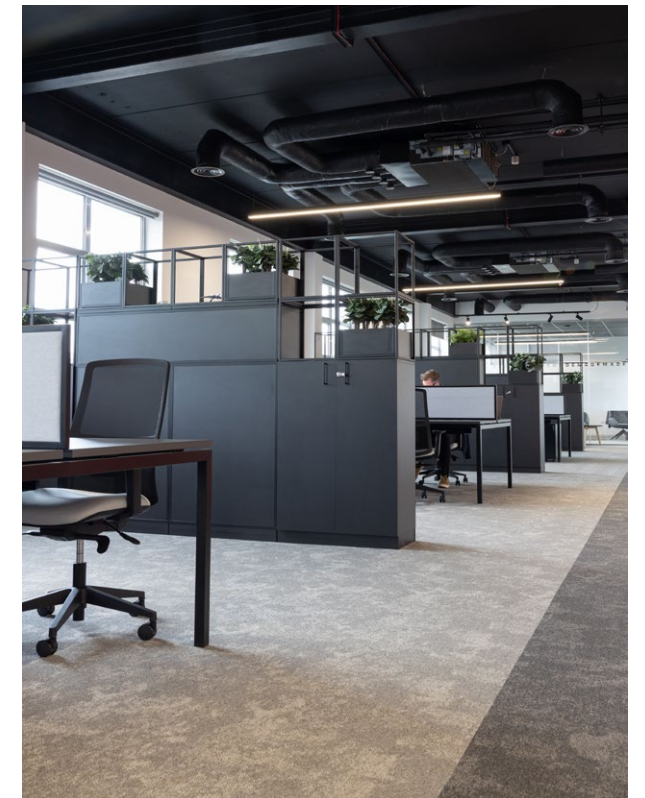

Explore Gerflor and Gradus' Innovative Looselay Solutions

This brochure provides a snapshot of how Gerflor and Gradus support multiple sectors with their innovative and market-leading looselay products. For a comprehensive look at our full range and to support your project, explore our detailed looselay guide.

Access the full guide: [download the PDF](#)

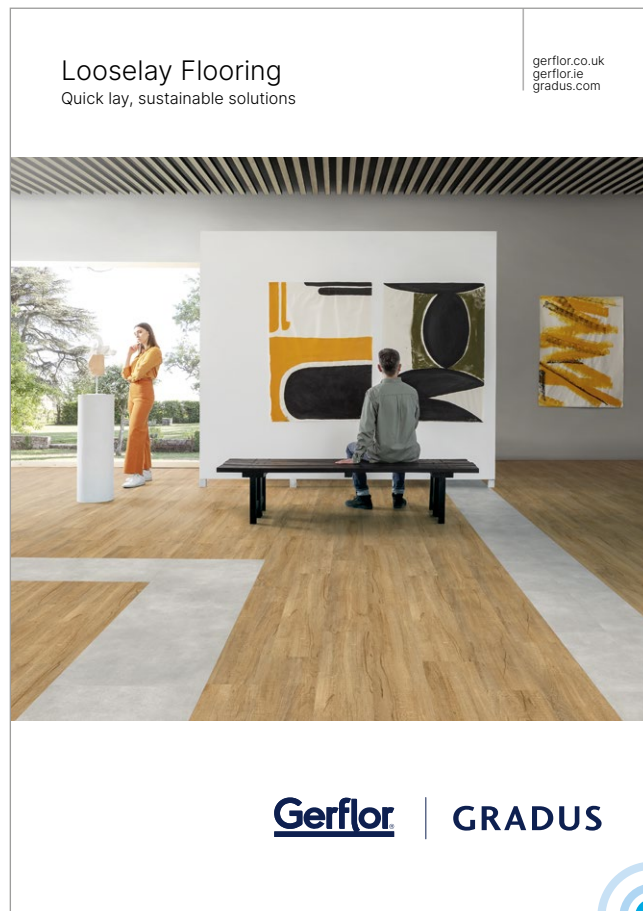

Scan the QR code to access the full guide



United Kingdom:
Gerflor Flooring UK Ltd
Park Green, Macclesfield,
Cheshire, SK11 7LZ
Tel: 01625 428922
E-mail: contractuk@gerflor.com

Ireland:
Gerflor Ltd
Ballybay Road, Co. Monaghan,
A81 YD83, Republic of Ireland
Tel: +353 (0) 42 966 1431
E-mail: gerflorirl@gerflor.com

gerflor.co.uk
gerflor.ie

follow us:

